



**Emco
Dynatorq**

Title: **ELECTROMAGNETIC BRAKE**
TYPE - 41.115 Design 1.1, 1.2, 1.3 (Normally Off)

Reference:
-

DIMENSIONS

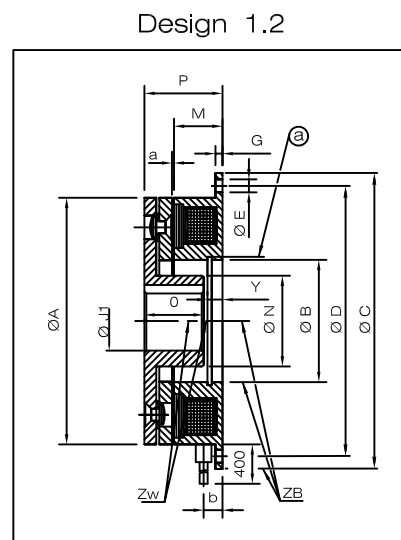
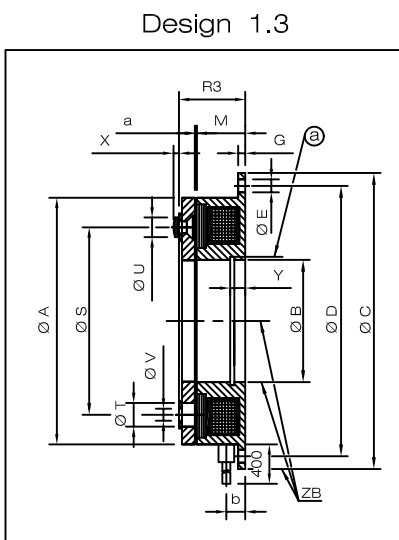
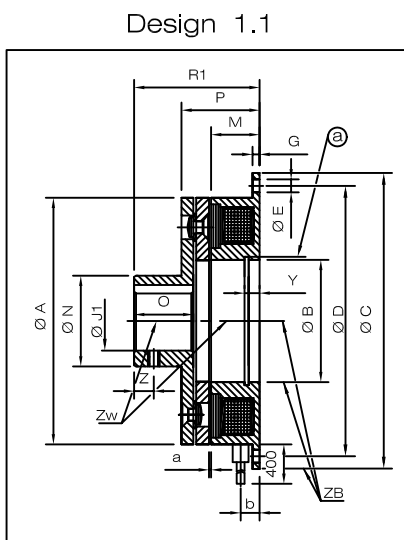

Tapped holes shown on dimension 'Z' on request.

PARAMETERS

Size		06	08	10	12	16	20	25
Torque	Ms [Nm]	7.5	15	30	60	120	240	480
Max. Speed	[min ⁻¹]	8000	6000	5000	4000	3000	3000	2000
Input Power	P20 [w]	11.5	16	21	28	38	45	70
Inertia [kg cm ²]	Armature	0.6	1.71	6.64	18	63.3	190	480
		3	0.42	1.18	4.72	13	48	137
Permissible misalignment	Zw [mm]	0.08	0.08	0.08	0.1	0.1	0.1	0.15
	ZB [mm]	0.2	0.2	0.2	0.2	0.3	0.3	0.3
	ØA	63	80	100	125	160	200	250
	ØB ^{H8}	35	42	52	62	80	100	125
	ØC ^{H9}	80	100	125	150	190	230	290
	ØD	72	90	112	137	175	215	270
	ØE	4.5 x 4	5.5 x 4	6.6 x 4	6.6 x 4	9 x 4	9 x 4	11 x 4
	G	2	2.5	3	3.5	4	5	6
	M	18	20	22	24	26	30	35
	ØN	27	32	42	49	65	83	105
	O	15	20	25	30	38	48	55
	P	25.5	28.5	32.9	37	42	50.4	58.9
	R1	37	44.5	52.9	61	73	89.4	102.9
	R3	22	24.5	27.9	31	35	41.4	47.9
	ØS	46	60	76	95	120	158	210
	ØT	6.3 x 3	8 x 3	10.5 x 3	12 x 3	15 x 3	18 x 3	22 x 4
	ØU	5.5 x 3	7 x 3	9 x 3	10 x 3	13 x 3	16 x 3	20 x 4
	ØV	3.1 x 3	4.1 x 3	5.15 x 3	6.1 x 3	8.2 x 3	10.2 x 3	12.2 x 4
	X	1.4	1.7	2.1	2.5	3	4	4.3
	Y	3.5	4.3	5	5.5	6	7	8
	Z	5	6	6	10	10	15	20
	a	0.2	0.2	0.2	0.3	0.3	0.5	0.5
	b	6.3	6.3	6.3	6.8	8.8	12.4	14.9
	ØJ ₁ ^{H7}	* 10 ** 10,12,15 *** 17	* 10 ** 15,17,20 *** 20	* 14 ** 20,25,28 *** 30	* 14 ** 25,28,30 *** 35	* 20 ** 30,35,40 *** 45	* 25 ** 40,50,55 *** 60	* 25 ** 40,50,60 *** 80

IMPORTANT : 1 Nm = 0.102 kgm = 0.737 lb. ft.
Standard voltages: 24 V.D.C.; 96 V.D.C.; 190 V.D.C.
Other voltages on request.
Ms: Dynamic Torque

All dimensions are in mm

keyways to DIN 6885/ IS:2048
⊗ Circlip grooves to DIN 472/ IS:3075(Part 2)
P : Coil power at 20° C in W

THIS DOCUMENT IS THE PROPERTY OF EMCO DYNATORQ PVT. LTD. UNAUTHORISED DISCLOSURE TO ANY THIRD PARTY OR DUPLICATION IS NOT PERMITTED

Drawn *Nulan*
Appr.
Date

Drng.No. **L3. 103**
Sheet 1 Of 1